

Tape Specifications for Surface Mounted Glass Diodes

We supply the SMD components either in bulk or in 8-mm or 12-mm blister tapes depending on type of case.

Both the tape dimensions for the cases MicroMELF, MiniMELF, QuadroMELF and MELF and dimensions of the reels are shown in the following figures.

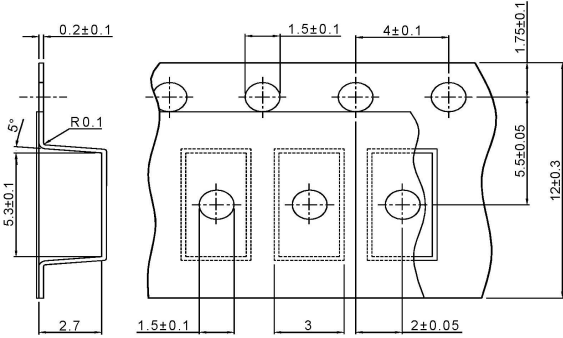

Accumulated pitch tolerance is ± 0.2 mm over 10 pitches

12-mm carrier tape for MELF package
dimensions in mm

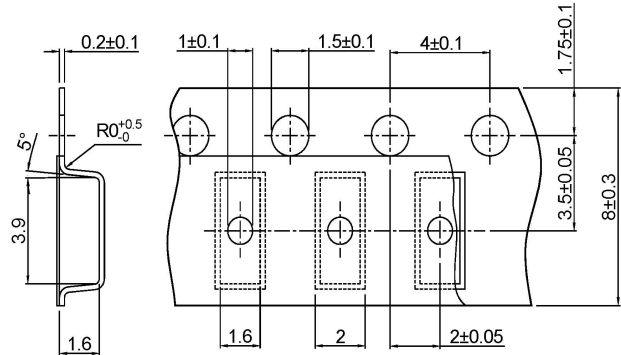

Accumulated pitch tolerance is ± 0.2 mm over 10 pitches

8-mm carrier tape for MiniMELF / QuadroMELF package
dimensions in mm

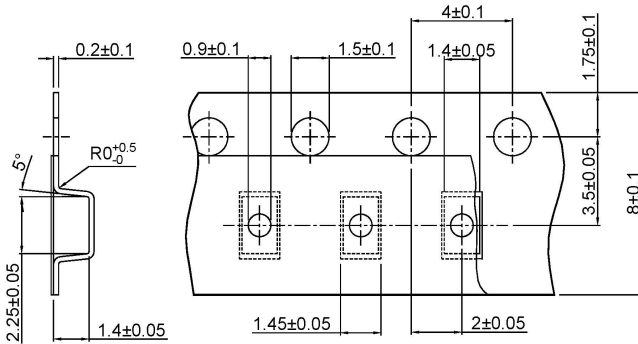

Accumulated pitch tolerance is ± 0.2 mm over 10 pitches

8-mm carrier tape for MicroMELF package
dimensions in mm