

Surface Mount Reel Specifications

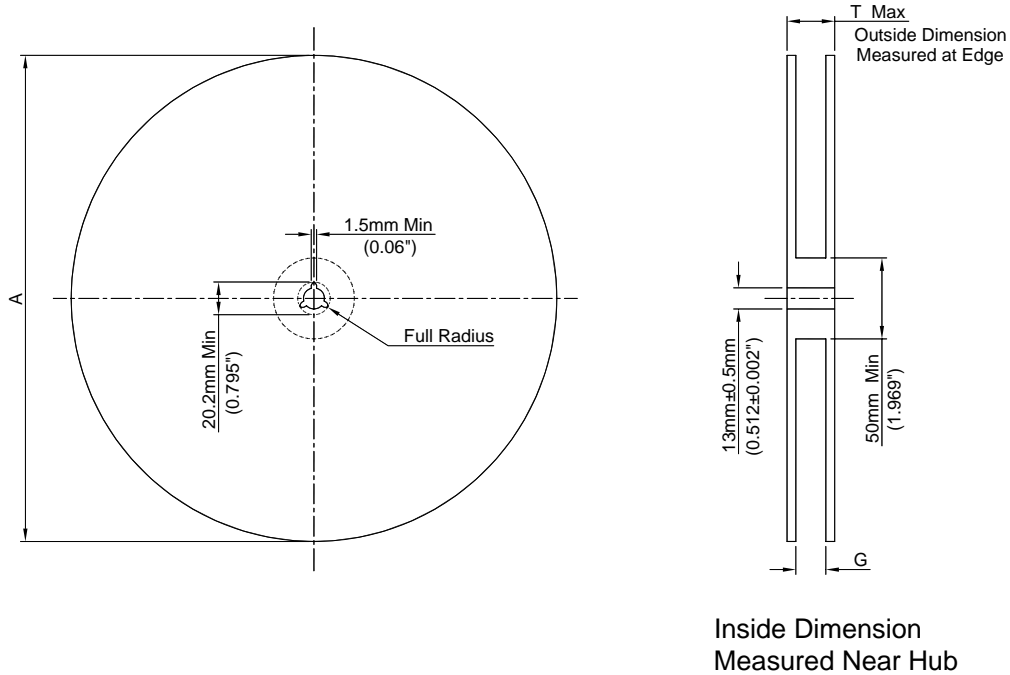

| Size | A (Max.) | G | T (Max.) |
|-------|-----------------------|---|-----------------------|
| 8 mm | 330 mm (12.992") | 8.4 mm + 1.5 mm, -0.0 (0.33" + 0.059", -0.00) | 14.4 mm (0.56") |
| 12 mm | 330 mm (12.992") | 12.4 mm + 2 mm, -0.0 (0.49" + 0.079", -0.00) | 18.4 mm (0.72") |
| 16 mm | 360 mm (14.173") | 16.4 mm + 2 mm, -0.0 (0.646" + 0.078", -0.00) | 22.4 mm (0.882") |
| 24 mm | 360 mm (14.173") | 24.4 mm + 2 mm, -0.0 (0.961" + 0.070", -0.00) | 30.4 mm (1.197") |

Reel Dimensions

Metric Dimensions Govern - English are in parentheses for reference only